

MURS CLAUSTRA 1-50

PORTES CHASSIS 1-50

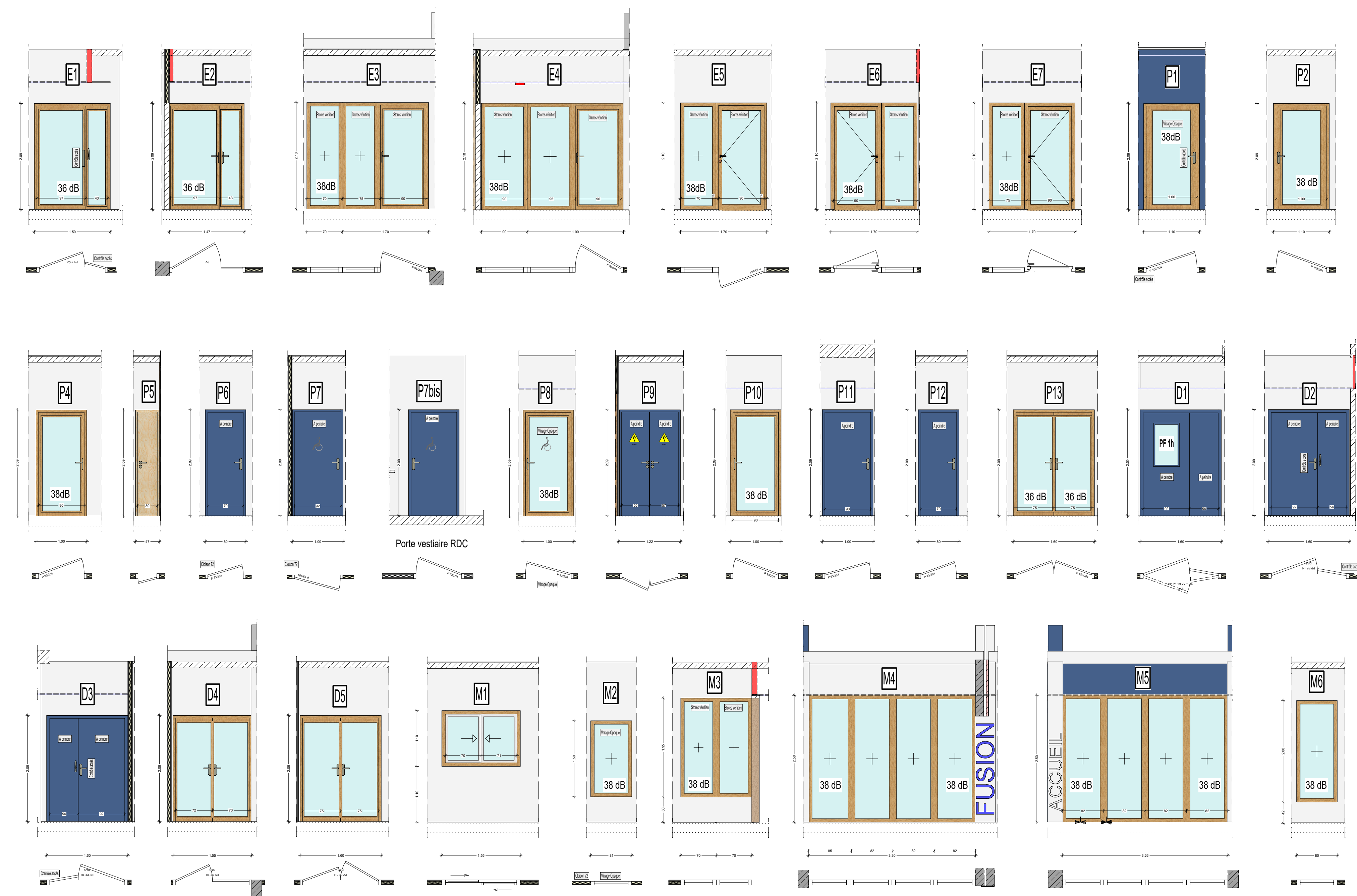

PLAN DE REPERAGE 1-75

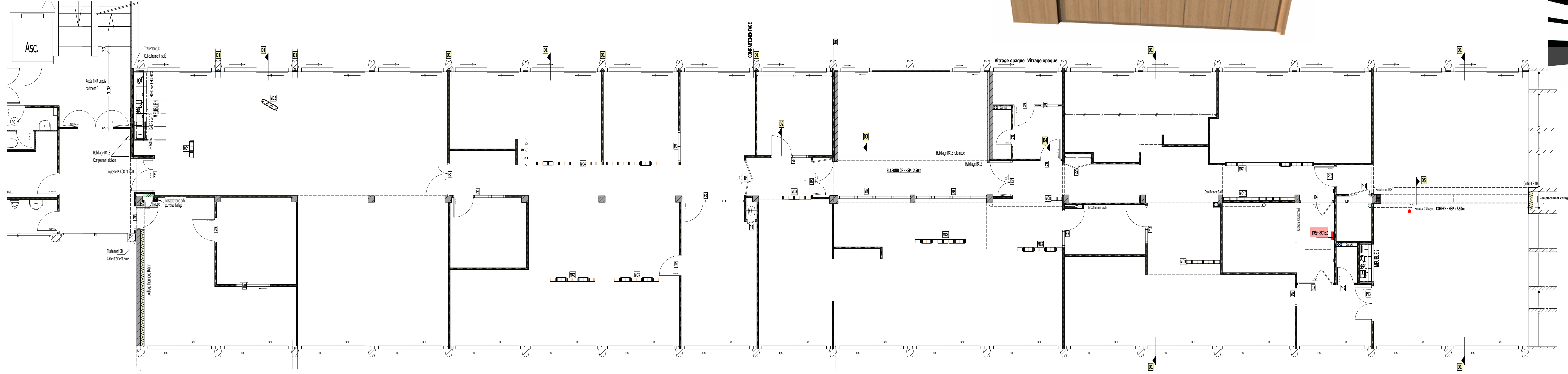

MEUBLE VESTIAIRE - CUISINE CONVIVIALITE et SALLE du CONSEIL 1-20

MEUBLE 1



MEUBLE 3 (Vestiaires RdC)

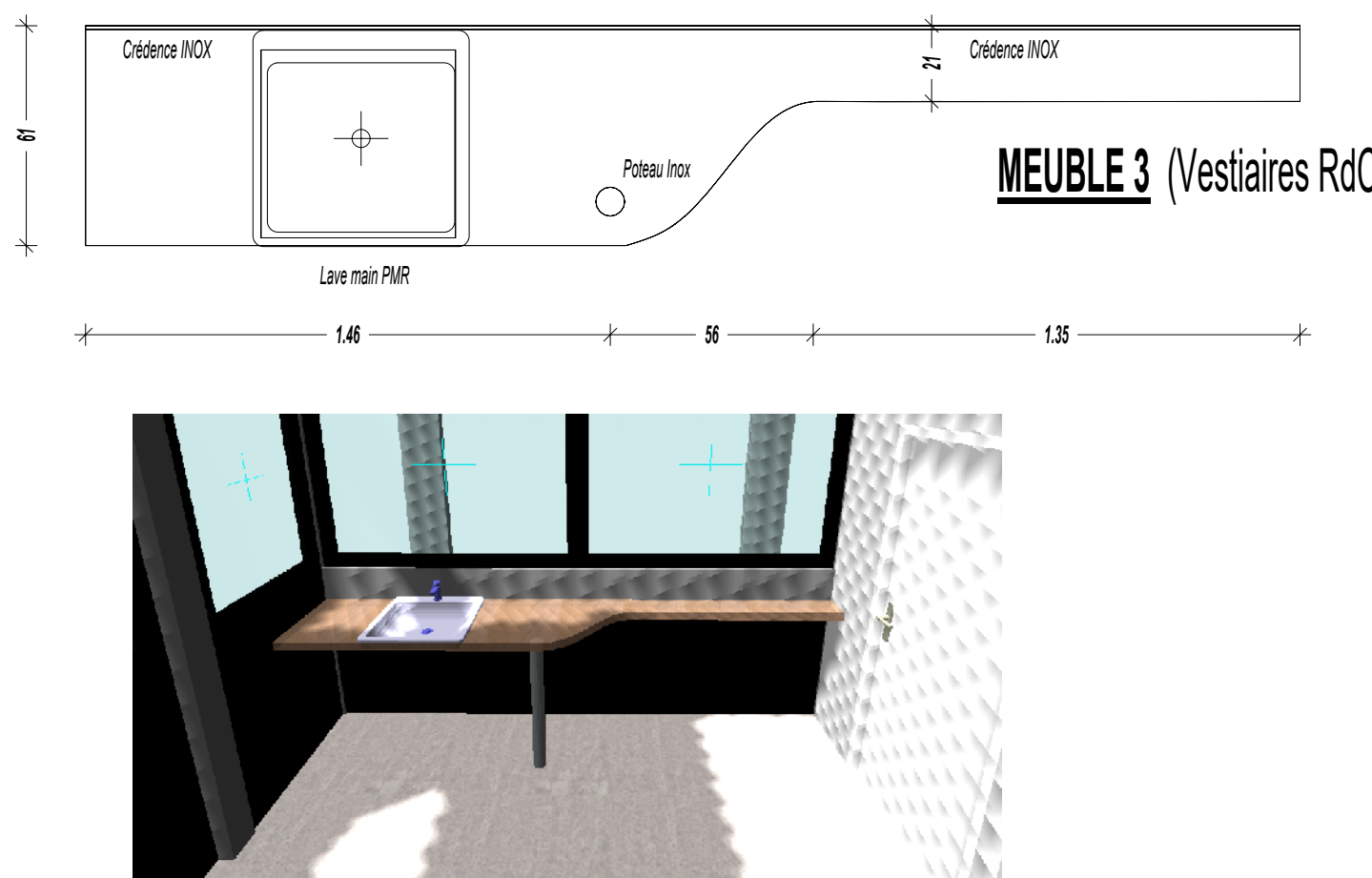

MEUBLE 2

